

210160 JUNTA ESTÁNDAR - VICTAULIC



Válvula de bola de DOS vías
Organo de mando: Palanca de acero inoxidable
Conexión: VICTAULIC
Paso: Total
Material: Aisi 316L (1.4404)
Tamaños: de DN20 a DN100
Sellos de junta: P.T.F.E. Virgen Modificado
Temperatura de funcionamiento: -20°C+170°C
Acabado externo: Arenado

A pedido:

Sistema antiestático ATEX:

II 2G Ex h IIC T4 Gb

II 2D Ex h IIIC T135°C Db

M.O.C.A. CE 1935/2004

• Sellos de junta en:

PTFE cargado vidrio -20°C+170°C

PTFE cargado carbogafito -20°C+180°C

PTFE cargado inox -20°C+200°C

UHMW Polietileno alta densidad -20°C+80°C

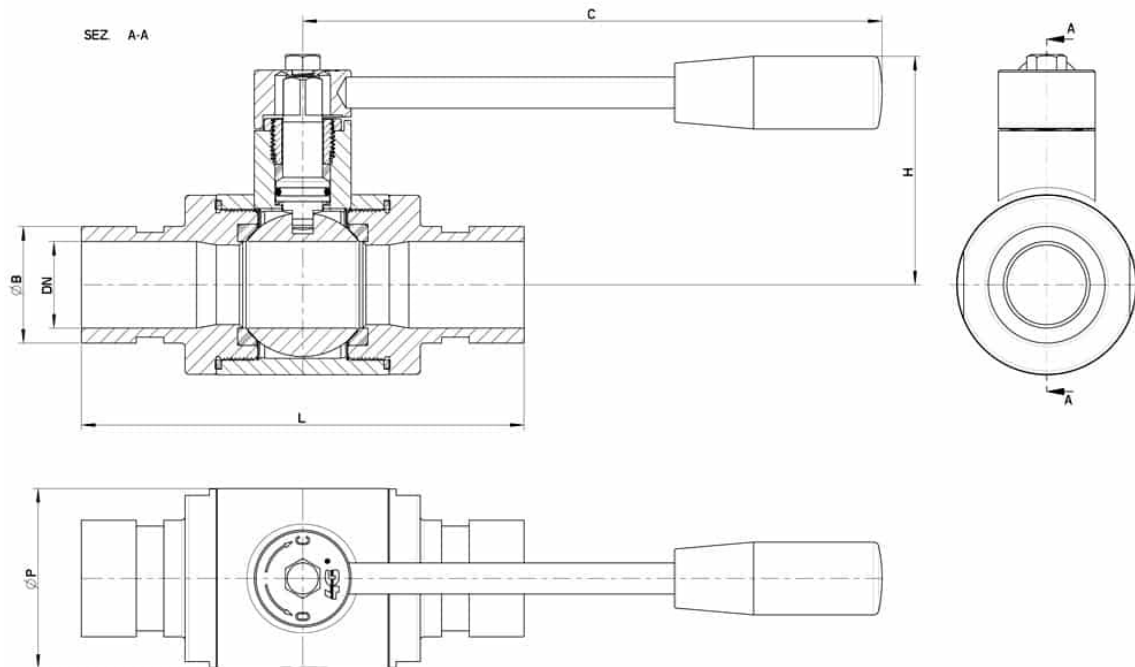

| VICTAULIC | DN | L | ØB | H | C | ØP | PN | Kg | CÓDIGO AISI 316 |
|--------------|-----|-----|-------|-----|-----|-----|-----|------|-----------------|
| 3/4" x 26,9 | 20 | 126 | 26.9 | 59 | 110 | 42 | 100 | 0.78 | 210160 62010 |
| 1" x 33,7 | 25 | 128 | 33.7 | 66 | 160 | 52 | 64 | 1.22 | 210160 62610 |
| 1"1/4 x 42,4 | 32 | 134 | 42.4 | 71 | 160 | 60 | 64 | 1.53 | 210160 63010 |
| 1"1/2 x 48,3 | 40 | 148 | 48.3 | 96 | 190 | 73 | 64 | 2.43 | 210160 63410 |
| 2" x 60,3 | 50 | 158 | 60.3 | 104 | 190 | 89 | 40 | 3.68 | 210160 63810 |
| 2"1/2 x 73 | 65 | 172 | 73 | 119 | 225 | 113 | 40 | 5.98 | 210160 64410 |
| 2"1/2 x 76.1 | 65 | 172 | 76.1 | 119 | 225 | 113 | 40 | -- | 210160 64510 |
| 3" x 88,9 | 80 | 194 | 88.9 | 130 | 290 | 136 | 40 | 9.12 | 210160 64810 |
| 4 x 114,3 | 100 | 206 | 114.3 | 144 | 325 | 167 | 25 | 14.9 | 210160 65410 |

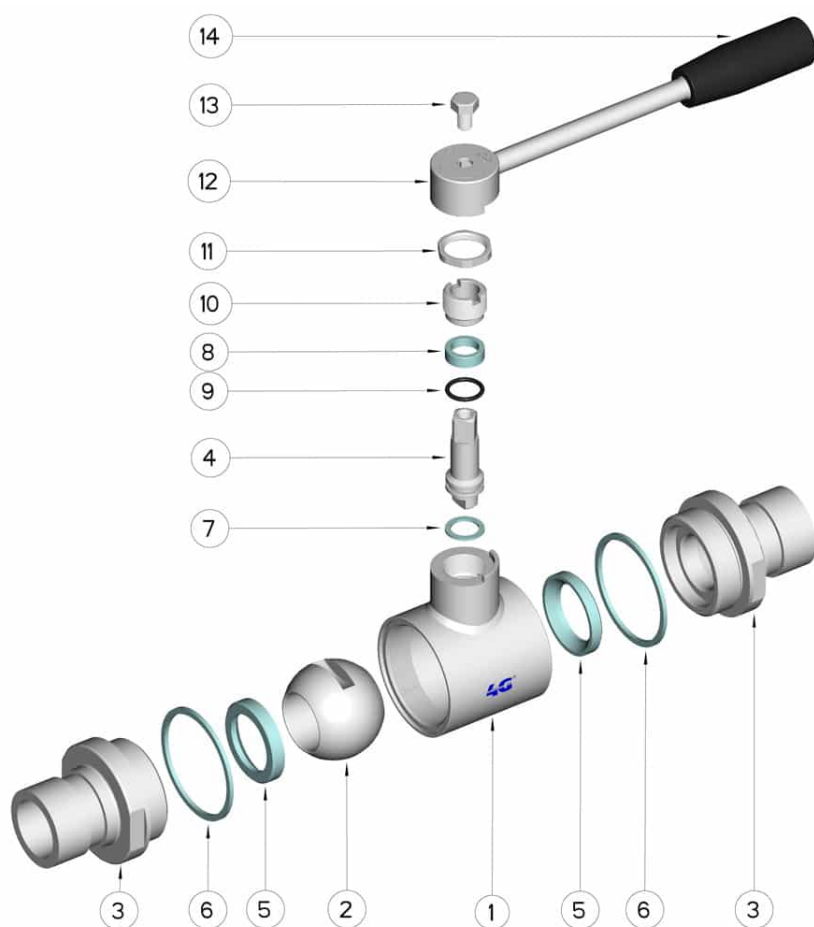

| POSICIÓN | DENOMINACIÓN | PIEZAS | MATERIAL |
|----------|---------------------|--------|------------------------|
| 1 | Cuerpo | 1 | AISI 316L |
| 2 | Bola | 1 | AISI 316L |
| 3 | Mangas | 2 | AISI 316L |
| 4 | Alfiler | 1 | AISI 316L |
| 5 | Sello bola | 2 | PTFE virgen modificado |
| 6 | Sello mangas | 2 | PTFE |
| 7 | Sello alfiler | 1 | PTFE |
| 8 | Sello alfiler | 1 | PTFE |
| 9 | OR de junta alfiler | 1 | FKM |
| 10 | Anillo de registro | 1 | AISI 304L (303) |
| 11 | Tuerca | 1 | AISI 304L |
| 12 | Arandela | 1 | AISI 304L |
| 13 | Palanca | 1 | AISI 304L |
| 14 | Mango | 1 | DUROPLAST (PF) |

