

## 766060 ISO 228 OGIVE NIPPLE X ISO 7 TAPERED THREAD

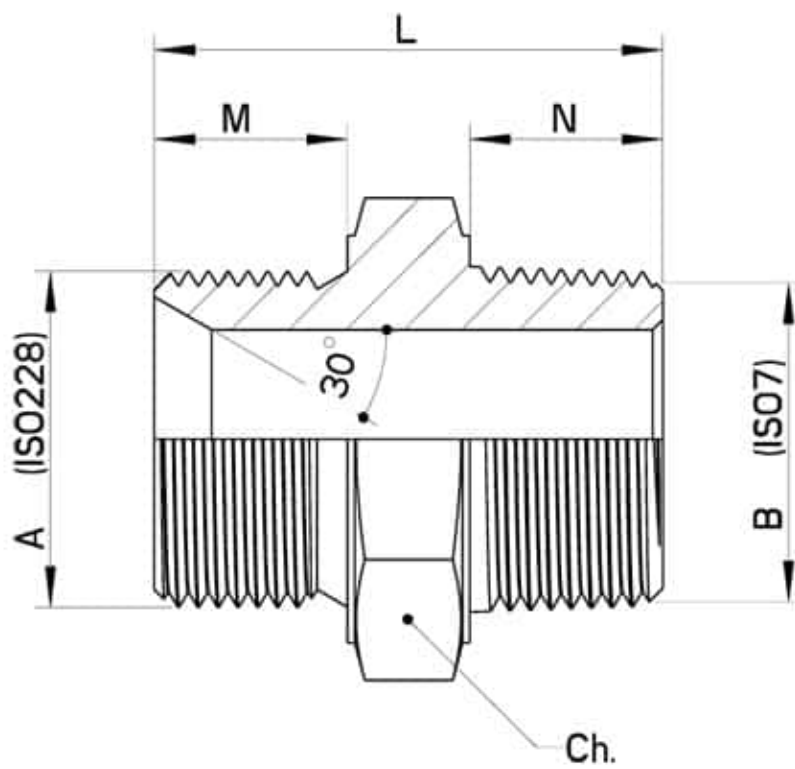

ISO 228 OGIVE Nipple CYLINDRICA THREAD X ISO 7 TAPERED THREAD  
Material: Aisi 316L (1.4404)

On request:  
M.O.C.A. CE 1935/2004



ISO228 X ISO7	M	N	Ch	L	Kg	CODE AISI 316L
1/8"	8	8	17	22	0,02	766060 60200
1/4"	11	11	19	29	0,027	766060 60300
3/8"	13	13	22	34	0,04	766060 60700
1/2"	15	15	27	39	0,08	766060 61100
3/4"	17	17	32	44	0,12	766060 61700
1"	19	19	41	50	0,21	766060 62300
1"1/4	21	21	50	56	0,336	766060 62700
1"1/2	22	22	55	58	0,48	766060 63400
2"	25	25	65	66	0,71	766060 64200
2"1/2	30	30	85	80	1,47	766060 65000
3"	30	30	100	82	1,60	766060 66000
4"	30	36	120	88	2,57	766060 67000



