

## 360130 T\_3 SEALS\_FOR BS PIPE



THREE-way ball valve three seals with "T" port  
Drive: Inox lever  
Connection: **CLAMP normative DIN 32676 TAB.4 REIHE C**  
**For TUBE according to normative BS/OD (ASTM A270)**  
Flow: Full and reduced  
Material: Aisi 304L (1.4307) - Aisi 316L (1.4404)  
Measure: from 2"1/2 to 4"  
Seals: Modified Virgin P.T.F.E.  
Operating temperature: -20°C+170°C  
Outer finish: Polished

On request:

Antistatic device ATEX:  
II 2G Ex h IIC T4 Gb  
II 2D Ex h IIIC T135°C Db  
M.O.C.A. CE 1935/2004

• Seals made of:

PTFE with glass -20°C+170°C  
PTFE with carbographite -20°C+180°C  
PTFE with inox -20°C+200°C  
UHMW High-molecular weight polyethylene -20°C+80°C

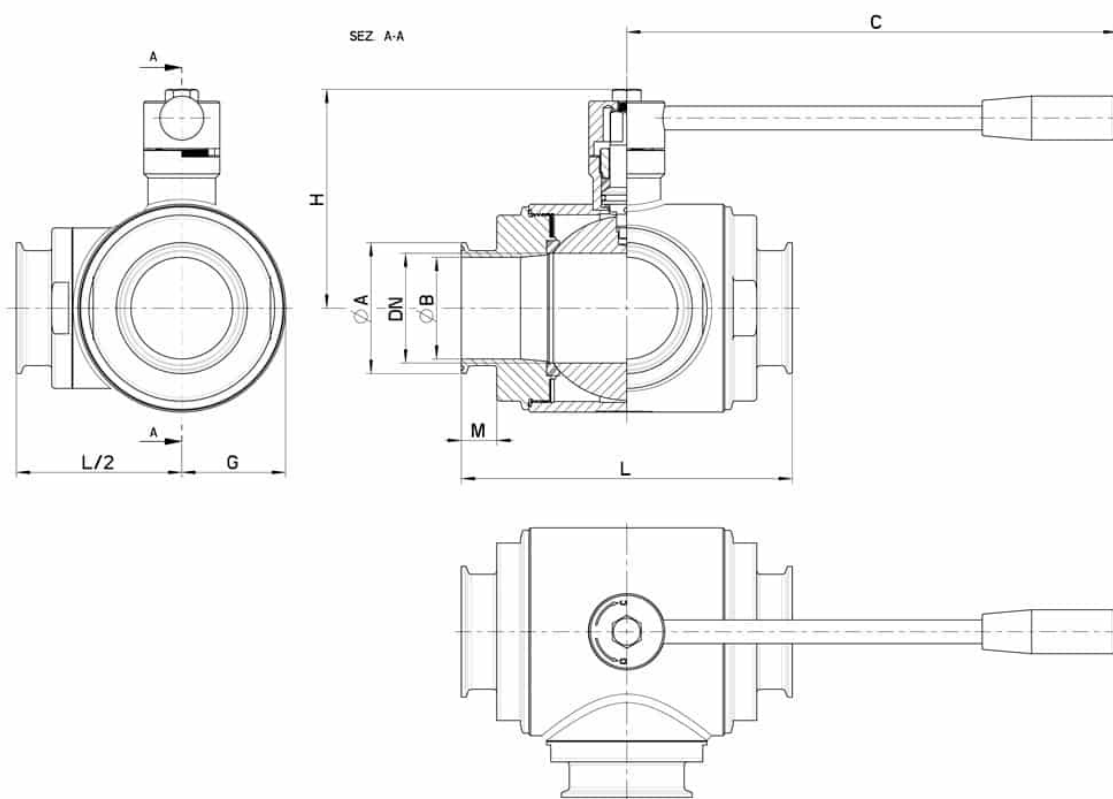

CLAMP REIHE C INCH	DN	L	G	Ø A	Ø B	C	H	PN	Kg	CODE AISI 316L
2"1/2	65	196	80	77,5	60,2	285	130	16	-	360130 64410
3"	80	256	100	91	72,9	310	145	16	-	360130 64810
4"	100	286	120	119	97,38	310	160	10	-	360130 65410

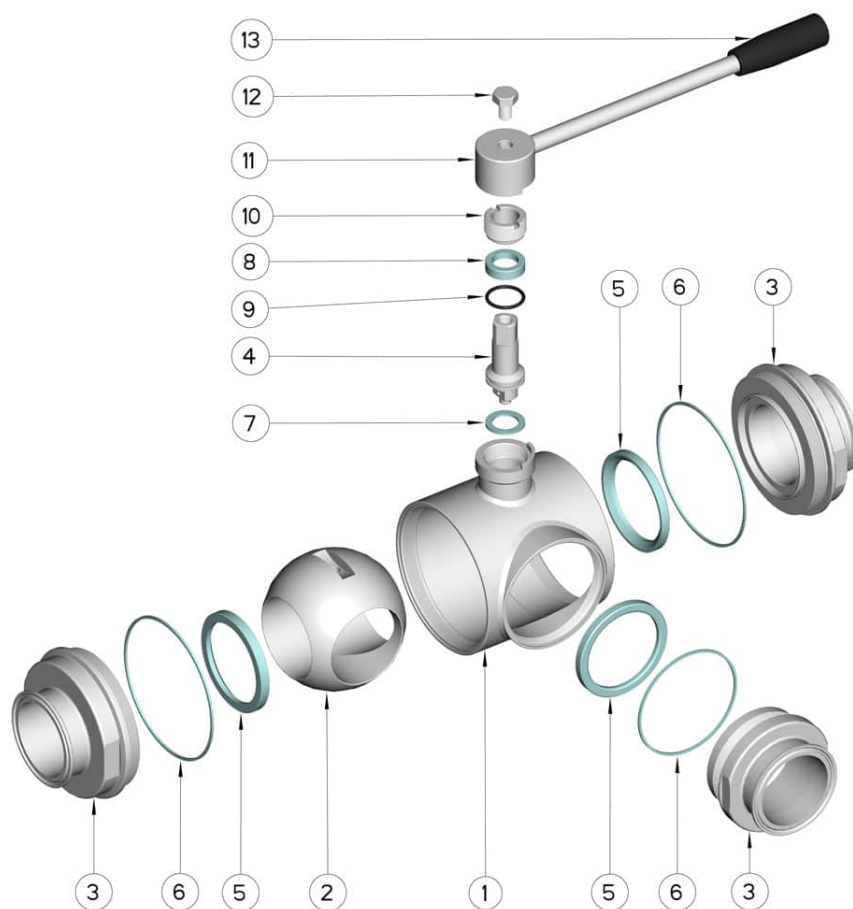

POS.	DENOMINATION	PCS	MAT.
1	Body	1	AISI 316L
2	Ball	1	AISI 316L
3	Sleeves	3	AISI 316L
4	Stem	1	AISI 316L
5	Ball Seals	3	PTFE Vergine Modificato
6	Sleeve Seals	3	NBR
7	Stem Seal	1	PTFE
8	Stem Seal	1	PTFE
9	Stem or-Seal	1	FKM
10	Register ring	1	AISI 304L (303)
11	Lever	1	AISI 304L
12	SCREW	1	AISI 304L
13	Handle	1	Resin

