

## 300142\_T\_STANDARD SEALS\_BUTT-WELDING IN ACCORDING TO BS-OD (ASTM A-270)



THREE-way ball valve 4 seals with "T" port  
Drive: Inox lever  
Connection: Butt-welding in according to BS-OD (ASTM A-270)  
Flow: Full  
Material: Aisi 316L (1.4404)  
Measure: DN10 a DN100  
Seals: Modified Virgin P.T.F.E.  
Operating temperature: -20°C+170°C  
Outer finish: Polished

On request:

Antistatic device ATEX:  
II 2G Ex h IIC T4 Gb  
II 2D Ex h IIIC T135°C Db  
M.O.C.A. CE 1935/2004

• Seals made of:

PTFE with glass -20°C+170°C  
PTFE with carbographite -20°C+180°C  
PTFE with inox -20°C+200°C  
UHMW High-molecular weight polyethylene -20°C+80°C

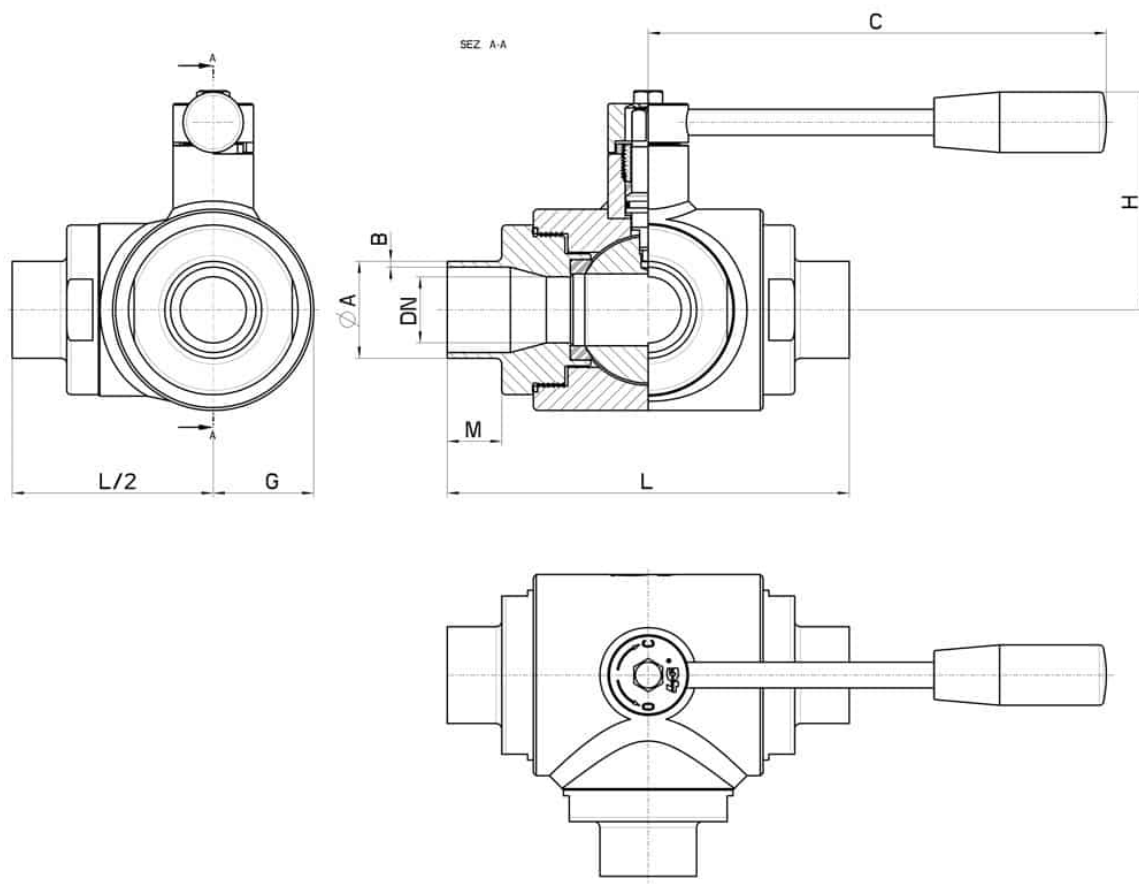

DN	ØA x B	M	L	G	C	H	PN	Kg	COD. AISI 316L
10	12,7 X 1,65	17	108	22,5	110	60	100	1,04	300142 6A710
15	19,05 X 1,65	18	118	26	110	65	100	1,34	300142 6B910
20	25,4 X 1,65	19	130	30	160	70	100	2,00	300142 6D710
25	25,4 X 1,65	19	140	35	160	76	64	2,77	300142 6D810
32	38,1 X 1,65	19	156	42,5	190	102	64	4,93	300142 6J910
40	38,1 X 1,65	19	172	50	190	110	64	7,24	300142 6K110
50	50,8 X 1,65	19	182	55	225	116	40	8,73	300142 6M810
65	63,5 X 1,65	21	196	80	290	125	40	10,63	300142 6R710
80	76,2 X 1,65	27	256	100	325	140	40	21,98	300142 6U510
100	101,6 X 2,11	27	286	120	325	155	16	34,55	300142 6X410

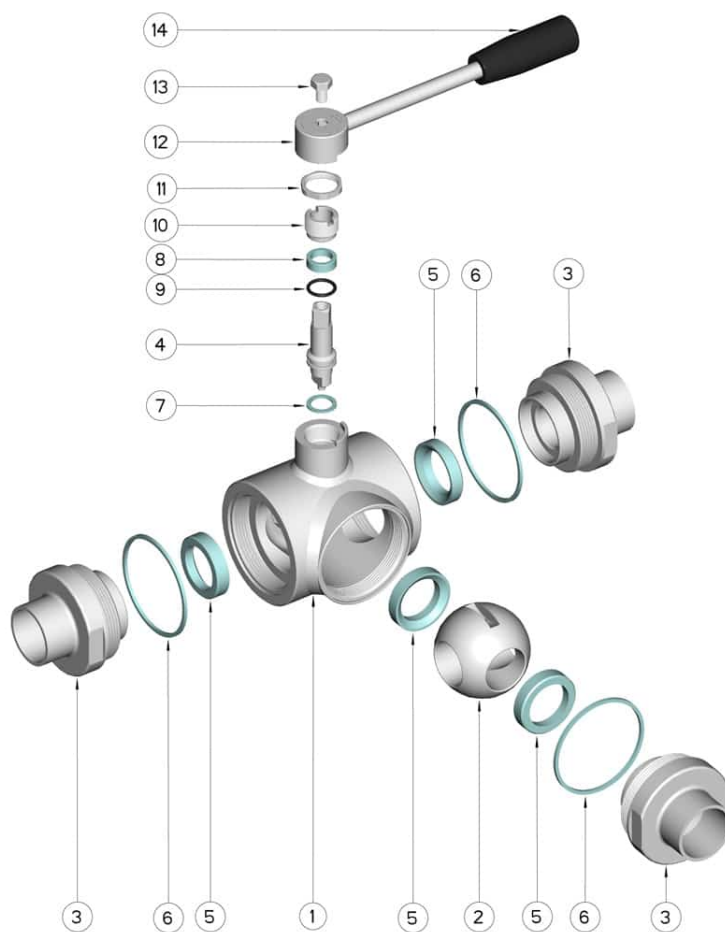

POS.	DENOMINATION	PCS	MAT.
1	Body	1	AISI 316L
2	Ball	1	AISI 316L
3	Sleeves	3	AISI 316L
4	Stem	1	AISI 316L
5	Ball Seals	4	PTFE Vergine Modificato
6	Sleeve Seals	3	PTFE
7	Stem Seal	1	PTFE
8	Stem Seal	1	PTFE
9	Stem or-Seal	1	FKM
10	Register ring	1	AISI 304L (303)
11	Nut	1	AISI 304L
12	Lever	1	AISI 304L
13	SCREW	1	AISI 304L
14	Handle	1	DUROPLAST (PF)

