

## 300104\_T\_4 SEALS STANDARD SEALS - F NPT



THREE-way ball valve 4 seals with "T"  
Drive: Inox lever  
Connection: NPT female/female/female thread  
Flow: Full  
Material: Aisi 316L (1.4404)  
Measure: from 1/4" to 4"  
Seals: Modified Virgin P.T.F.E.  
Operating temperature: -20°C+170°C  
Outer finish: Polished

On request:

Antistatic device ATEX:

II 2G Ex h IIC T4 Gb

II 2D Ex h IIIC T135°C Db

M.O.C.A. CE 1935/2004

• Seals made of:

PTFE with glass -20°C+170°C

PTFE with carbographite -20°C+180°C

PTFE with inox -20°C+200°C

UHMW High-molecular weight polyethylene -20°C+80°C

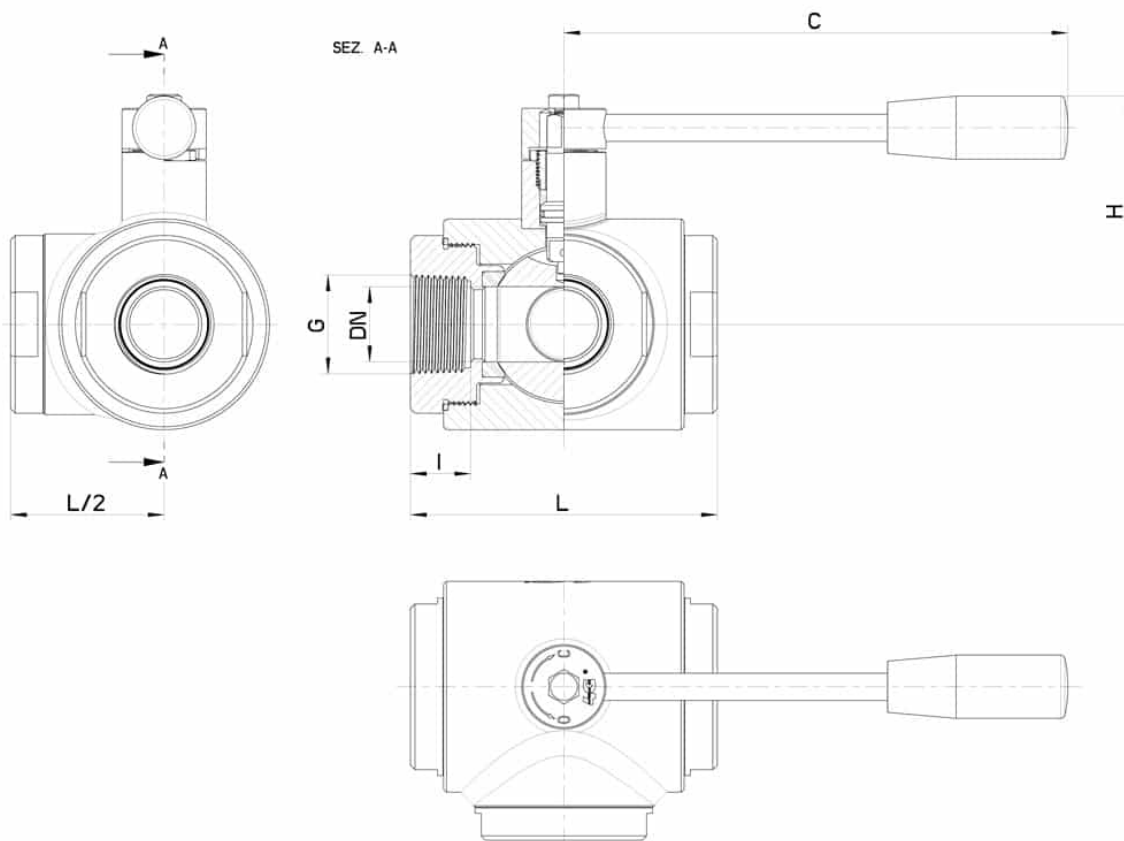

G (NPT)	DN	L	I	C	H	PN	Kg	CODE AISI 316L
1/4"	12	72	14	110	60	100	0,97	300104 60410
3/8"	12	72	16	110	60	100	0,90	300104 60810
1/2"	15	82	18	110	65	100	1,25	300104 61410
3/4"	20	92	19	160	70	100	1,90	300104 62010
1"	25	102	20	160	76	64	2,56	300104 62610
1"1/4"	32	118	20	190	102	64	4,57	300104 63010
1"1/2"	40	134	20	190	110	64	6,81	300104 63410
2"	50	144	20	225	116	40	8,24	300104 63810
2"1/2"	65	160	26	290	125	40	10,45	300104 64410
3"	80	200	28	325	140	40	21,21	300104 64810
4"	100	240	30	325	155	16	33,70	300104 65410

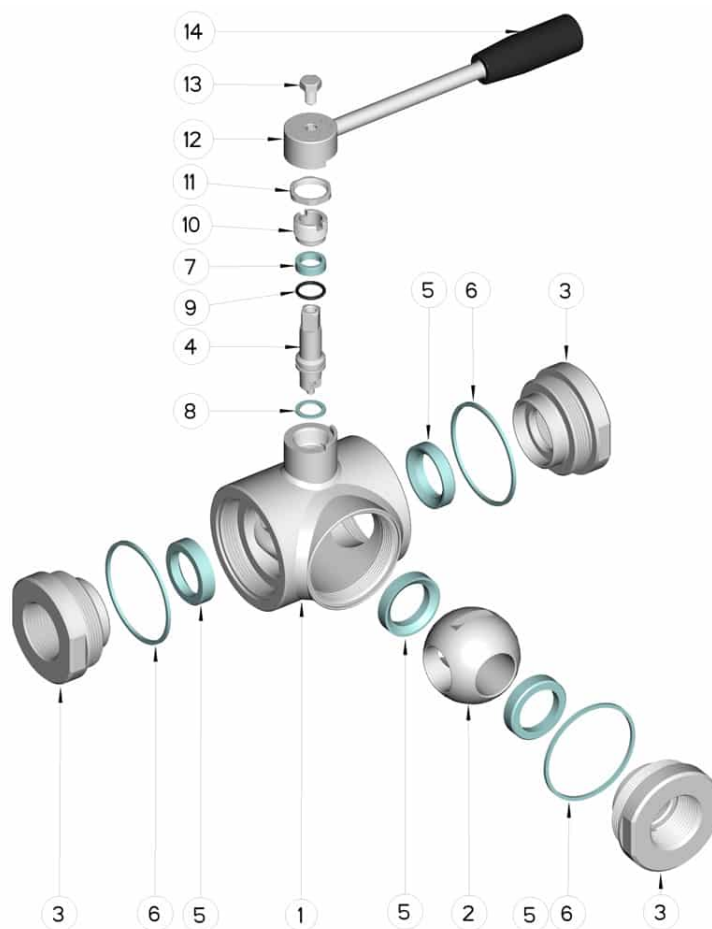

POS.	DENOMINATION	PCS	MAT.
1	Body	1	AISI 316L
2	Ball	1	AISI 316L
3	Sleeves	3	AISI 316L
4	Stem	1	AISI 316L
5	Ball Seals	4	PTFE Vergine Modificato
6	Sleeve Seals	3	PTFE
7	Stem Seal	1	PTFE
8	Stem Seal	1	PTFE
9	Stem or-Seal	1	FKM
10	Register ring	1	AISI 304L (303)
11	Nut	1	AISI 304L
12	Washer	1	AISI 304L
13	Lever	1	AISI 304L
14	Handle	1	DUROPLAST (PF)

