

130130C FOR ISO PIPE - HEATING JACKET



TWO-way ball valve "Integral Seal" with HEATING JACKET

Drive: Inox lever

Connection: **CLAMP normative DIN 32676 TAB.3 REIHE B**
For TUBE according to normative ISO 1127

Flow: Full and reduced

Material: Aisi 316L (1.4404)

Measure: from DN25 to DN100

Seals: Virgin P.T.F.E.

Operating temperature: -20°C+160°C

Outer finish: Polished

On request:

Antistatic device ATEX:

II 2G Ex h IIC T4 Gb

II 2D Ex h IIIC T135°C Db

M.O.C.A. CE 1935/2004

• Seals made of:

PTFE with glass -20°C+170°C

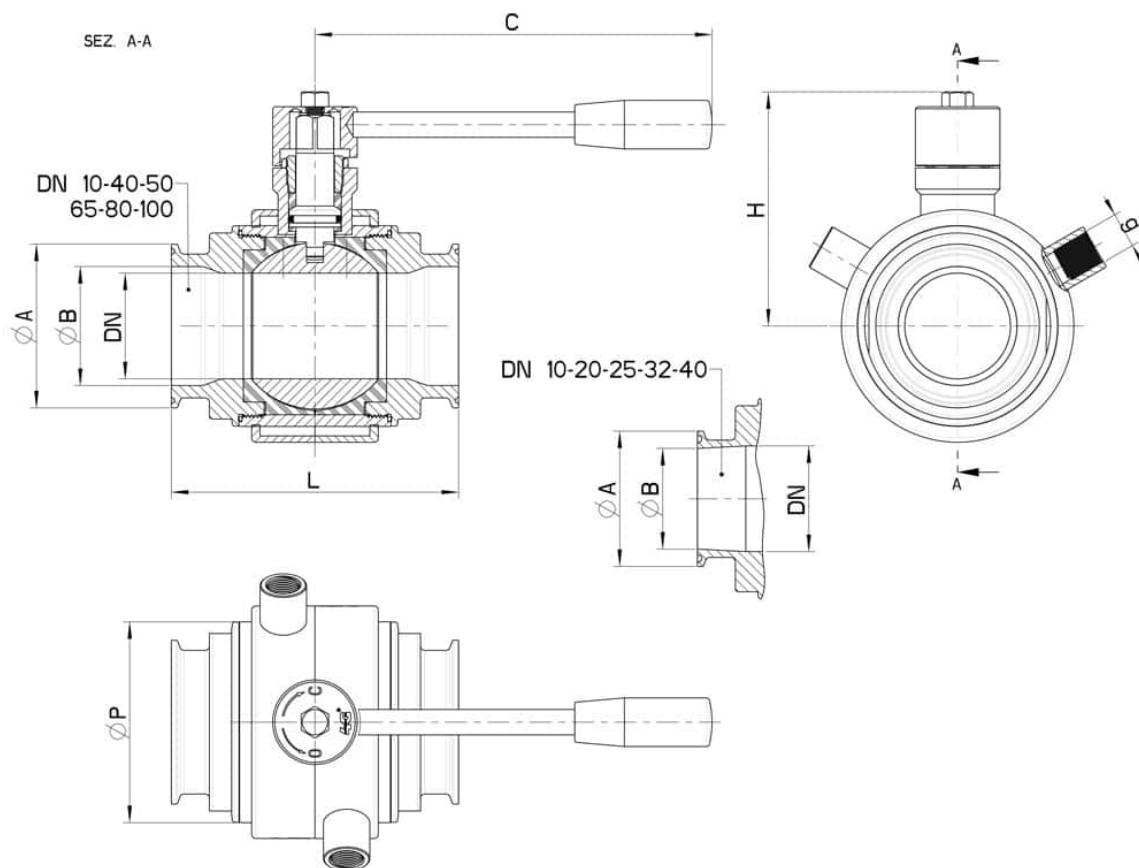

| CLAMP SERIE B DN/OD | DN | L | Ø A | Ø B | C | H | Ø P | g | PN | Kg | CODE AISI 316L |
|---------------------|-----|-----|------|-------|-----|-----|-----|------|----|----|----------------|
| 26.9 | 25 | 106 | 50,5 | 23.7 | 160 | 70 | 52 | 1/4" | 64 | - | 130130C62510 |
| 33.7 | 32 | 112 | 50,5 | 29.7 | 160 | 75 | 60 | 1/4" | 64 | - | 130130C63110 |
| 42.4 | 40 | 126 | 64 | 38.4 | 190 | 85 | 73 | 3/8" | 64 | - | 130130C63310 |
| 48.3 | 40 | 126 | 64 | 44.3 | 190 | 85 | 73 | 3/8" | 64 | - | 130130C63710 |
| 60.3 | 50 | 136 | 77.5 | 56.3 | 190 | 95 | 88 | 3/8" | 40 | - | 130130C64110 |
| 76.1 | 65 | 154 | 91 | 72.1 | 220 | 115 | 113 | 1/2" | 40 | - | 130130C64710 |
| 88.9 | 80 | 184 | 106 | 84.3 | 285 | 135 | 135 | 1/2" | 40 | - | 130130C65110 |
| 114.3 | 100 | 190 | 130 | 109.7 | 310 | 150 | 167 | 1/2" | 25 | - | 130130C65310 |

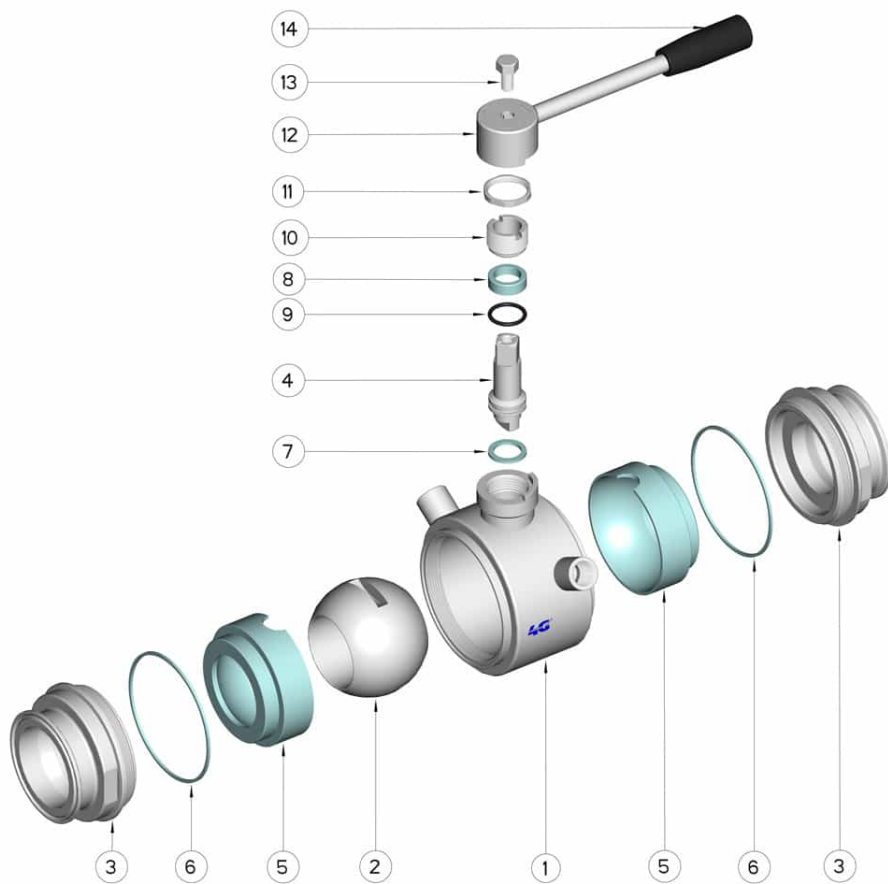

| POS. | DENOMINATION | PCS | MAT. |
|------|---------------|-----|-----------------|
| 1 | Body | 1 | AISI 316L |
| 2 | Ball | 1 | AISI 316L |
| 3 | Sleeves | 2 | AISI 316L |
| 4 | Stem | 1 | AISI 316L |
| 5 | Ball Seals | 2 | PTFE |
| 6 | Sleeve Seals | 2 | PTFE |
| 7 | Stem Seal | 1 | PTFE |
| 8 | Stem Seal | 1 | PTFE |
| 9 | Stem or-Seal | 1 | FKM |
| 10 | Register ring | 1 | AISI 304L (303) |
| 11 | Nut | 1 | AISI 304L |
| 12 | Lever | 1 | AISI 304L |
| 13 | SCREW | 1 | AISI 304L |
| 14 | Handle | 1 | DUROPLAST (PF) |

