

## 100155 STANDARD SEALS\_REVOLVING THREADED FLANGES EN 1759-1 CLASS 150

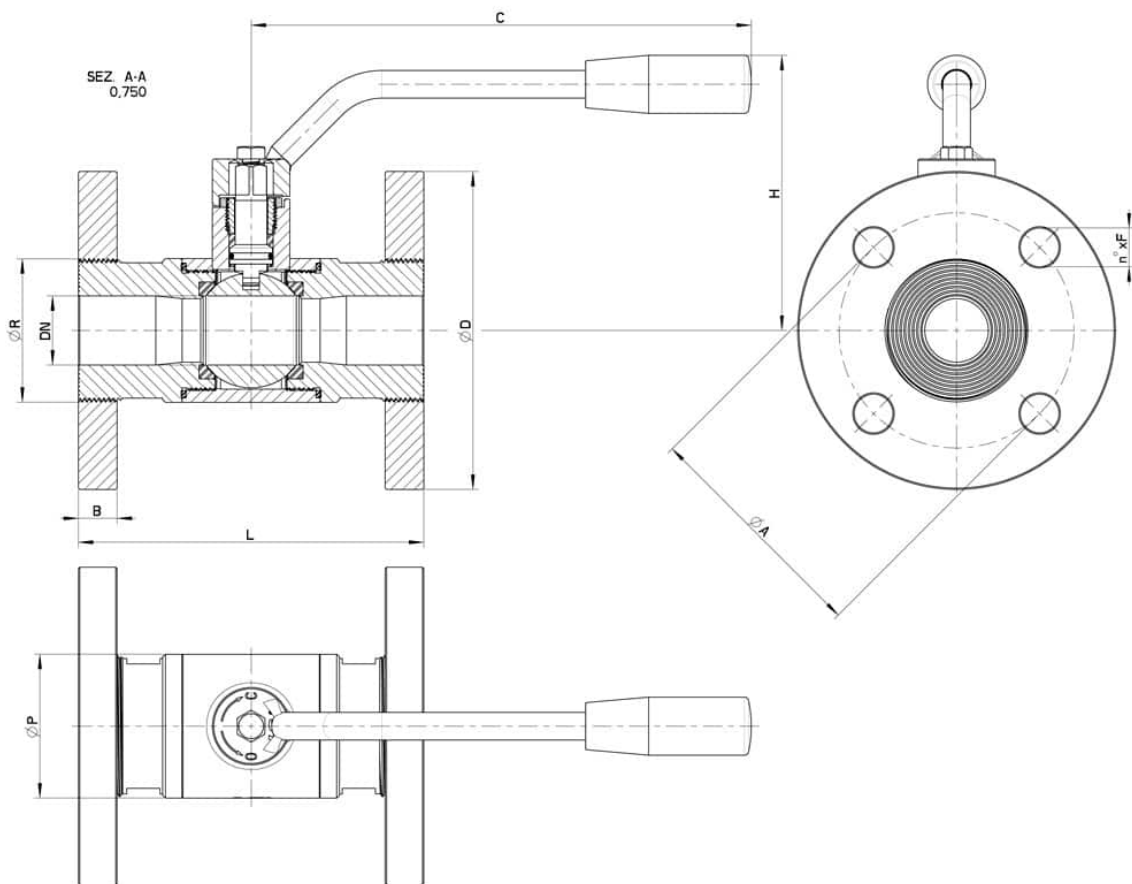

TWO-way ball valve  
Drive: Inox lever  
Connection: Revolving threaded flanges EN 1759-1 CLASS 150  
Flow: Full  
Material: Aisi 304L (1.4307) - Aisi 316L (1.4404)  
Measure: from 1/2" to 4"  
Seals: Modified Virgin P.T.F.E.  
Operating temperature: -20°C+170°C  
Outer finish: Polished

On request:  
Antistatic device ATEX:  
II 2G Ex h IIC T4 Gb  
II 2D Ex h IIIC T135°C Db  
M.O.C.A. CE 1935/2004  
• Seals made of:  
PTFE with glass -20°C+170°C  
PTFE with carbographite -20°C+180°C  
PTFE with inox -20°C+200°C  
UHMW High-molecular weight polyethylene -20°C+80°C



CLASS 150	DN	L	C	H	Ø P	Ø D	B	Ø R	A	n° x F	Kg	CODE AISI 304L	CODE AISI 316L
1/2"	15	115	125	74	35	88,9	9,5	34	60.6	4x16	1,80	-	100155 61410
3/4"	20	120	125	78	42	98,4	11,1	42	69.8	4x16	2,55	-	100155 62010
1"	25	125	170	92	52	108	12,7	51	79.4	4x16	3	-	100155 62610
1" 1/4	32	130	170	97	60	117,5	14,3	63	88.9	4x16	5,10	-	100155 63010
1" 1/2	40	140	245	130	73	127	15,9	75	98.4	4x16	5,42	-	100155 63410
2"	50	150	245	135	89	152,4	17,4	89	120.6	4x19	8,29	-	100155 63810
2" 1/2	65	170	260	159	113	177,8	20,6	110	139.7	4x19	13,00	-	100155 64410
3"	80	180	300	170	136	190,5	22,2	120	152.4	4x19	16,10	100155 44810	100155 64810
4"	100	190	330	190	167	228,6	22,2	140	190.5	8x19	24	100155 45410	100155 65410

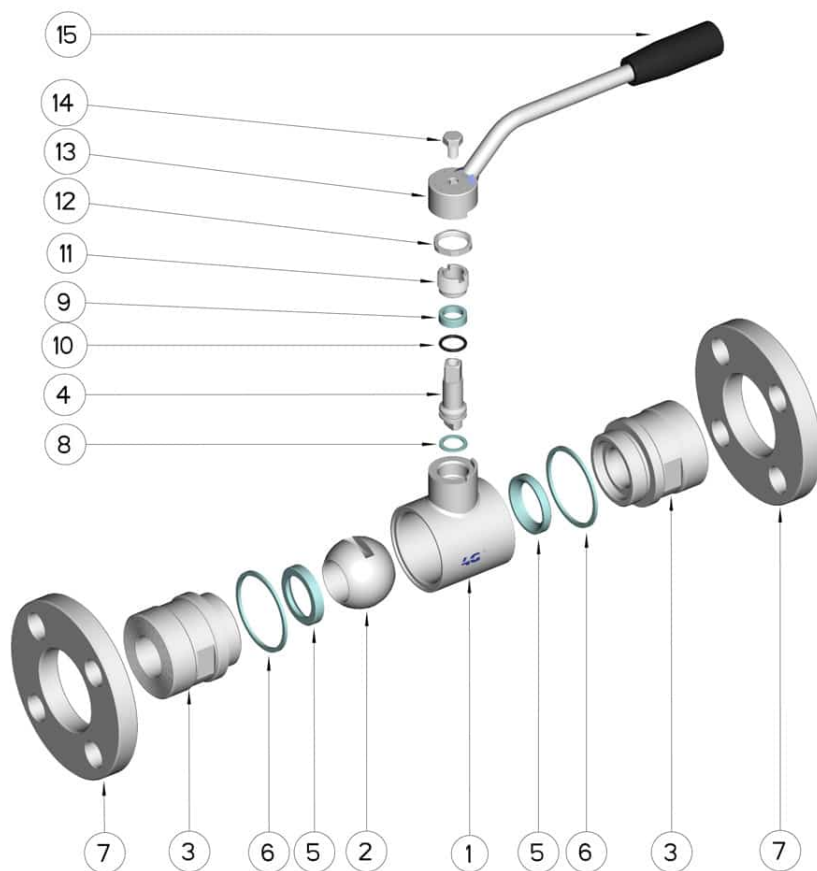

POSITION	DENOMINATION	PIECES	MATERIAL
1	Body	1	AISI (304L) 316L
2	Ball	1	AISI (304L) 316L
3	Sleeves	2	AISI (304L) 316L
4	Stem	1	AISI (304L) 316L
5	Ball Seals	2	PTFE
6	Sleeve Seals	2	PTFE
7	Flanges	2	AISI (304L) 316L
8	Stem Seal	1	PTFE
9	Stem Seal	1	PTFE
10	Stem or-Seal	1	FKM
11	Register ring	1	AISI 303
12	Locknut	1	AISI 303
13	Lever	1	AISI 304L
14	SCREW	1	AISI 304L
15	Handle	1	DUROPLASTO (PF)

