

100142_STANDARD SEALS_BUTT-WELDING IN ACCORDING TO ISO 1127



TWO-way ball valve
Drive: Inox lever
Connection: Butt-welding in according to ISO 1127
Flow: Full
Material: Aisi Aisi 316L (1.4404)
Measure: from DN10 to DN100
Seals: Modified Virgin P.T.F.E.
Operating temperature: -20°C+170°C
Outer finish: Polished

On request:

Antistatic device ATEX:

II 2G Ex h IIC T4 Gb

II 2D Ex h IIIC T135°C Db

M.O.C.A. CE 1935/2004

• Seals made of:

PTFE with glass -20°C+170°C

PTFE with carbographite -20°C+180°C

PTFE with inox -20°C+200°C

UHMW High-molecular weight polyethylene -20°C+80°C

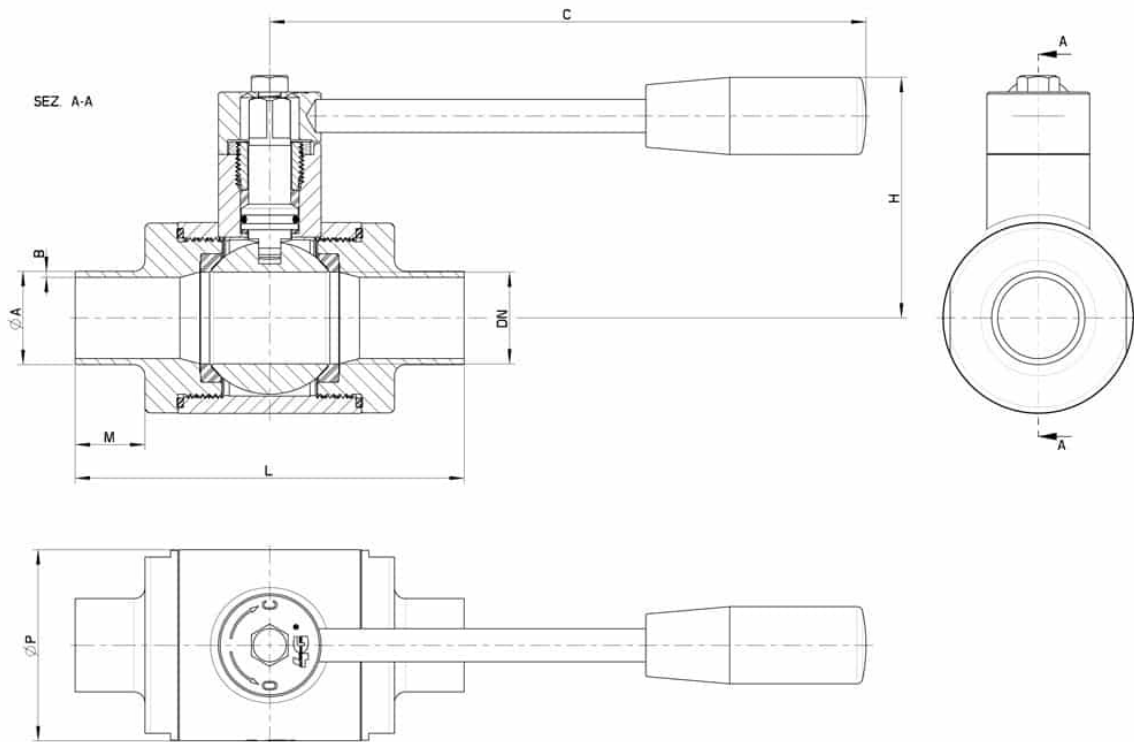

DN	L	C	H	Ø P	M	ØA x B	PN	Kg	CODE AISI 316L
10	88	110	53	30	16	17,2 x 1,65	100	--	100142 6B310
15	92	110	55	35	16	21,3 x 1,65	100	0,486	100142 6C210
20	102	110	59	42	18	26,9 x 1,65	100	--	100142 6E310
25	106	160	66	52	19	33,7 x 2	64	1,10	100142 6H910
32	112	160	71	60	19	42,4 x 2	64	1,34	100142 6L210
40	126	190	96	73	19	48,3 x 2	64	2,35	100142 6M110
50	136	190	104	89	19	60,3 x 2	40	3,40	100142 6Q910
65	154	225	119	113	21	76,1 x 2	40	5,75	100142 6U610
80	184	290	130	136	27	88,9 x 2	40	--	100142 6W910
100	190	325	144	167	27	114,3 x 2	25	--	100142 6Y410

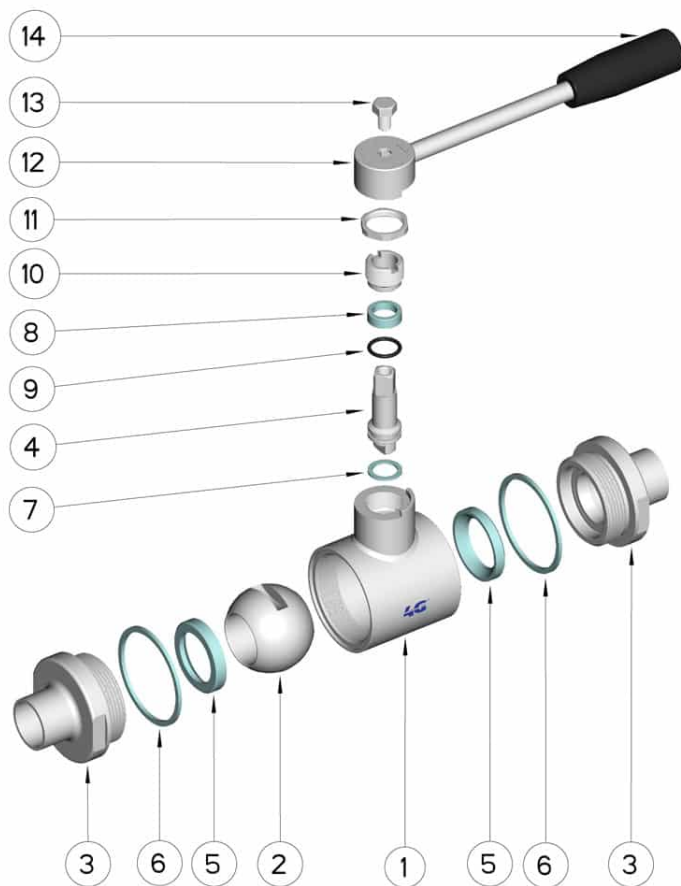

POSITION	DENOMINATION	PIECES	MATERIAL
1	Body	1	AISI 316L
2	Ball	1	AISI 316L
3	Sleeves	2	AISI 316L
4	Stem	1	AISI 316L
5	Ball Seals	2	PTFE
6	Sleeve Seals	2	PTFE
7	Stem Seal	1	PTFE
8	Stem Seal	1	PTFE
9	Stem or-Seal	1	FKM
10	Register ring	1	AISI 303
11	Locknut	1	AISI 303
12	Washer	1	AISI 304L
13	Lever	1	AISI 304L
14	Handle	1	DUROPLASTO (PF)

