

9354112 KIT LEVA PER VALVOLE ISO 5211

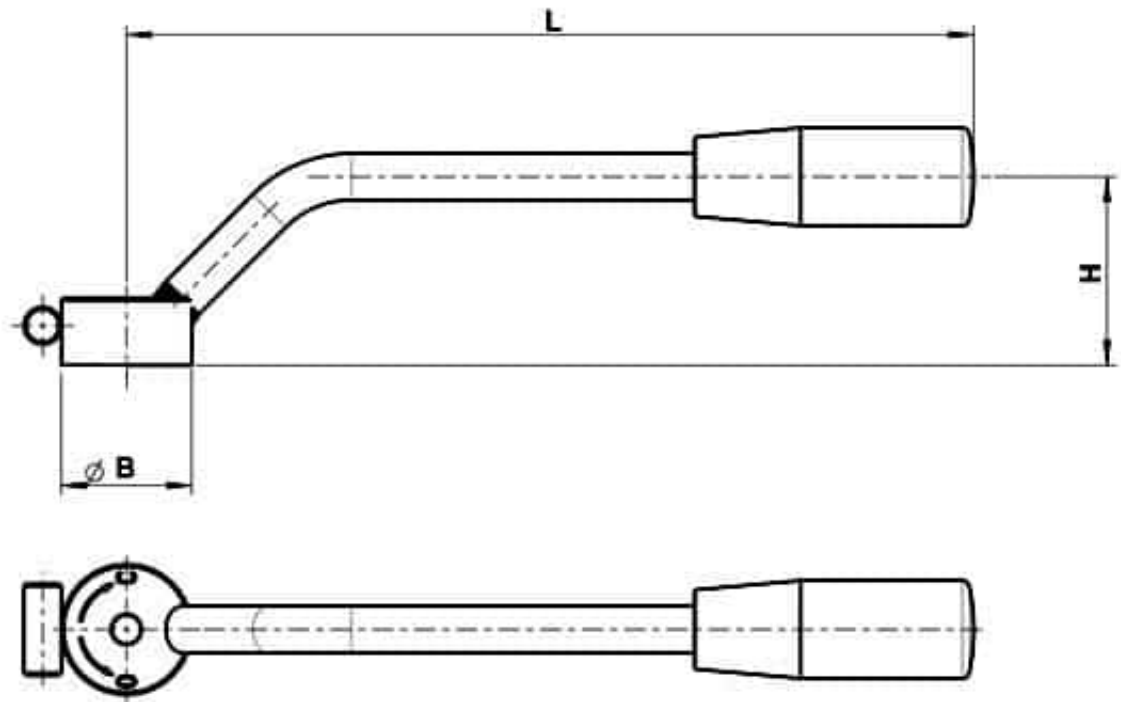

LEVA CON FERMO per CORPO PIATTO (Wafer) Art. 41 e 42
Materiale leva: Aisi 304L (1.4307)
Materiale impugnatura: DUROPLAST (PF)



DN VALVOLA	B	□	L	H	kg	COD
15	24	F03-06	130	27,5	0,115	9354112 4220
20 - 25	28	F04-9	181	39	0,19	9354112 4260
32 - 40 - 50	35	F05-14	240	47	0,43	9354112 4380
65	40	F07-17	268	54	0,61	9354112 4480
80	40	F07-17	298	54	0,72	9354112 4500
100	45	F10-17	325	61	0,84	9354112 4550

